

# Quick Start Guide

## Contact Us



### Email Us

Technical Support  
[support@iliferobot.com](mailto:support@iliferobot.com)



### Tweet Us

@ILIFEROBOTICS  
Mon-Fri: 9:00AM - 18:00pm

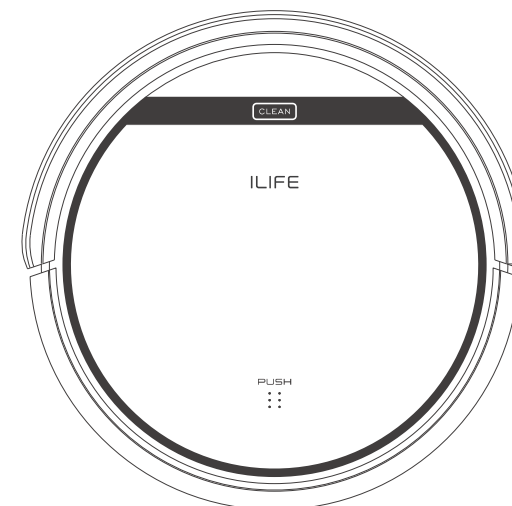

## ILIFE Customer Service

Toll-Free Number:  
1-800-631-9676 (Toll free for USA & Canada)  
Monday-Friday from 9:00 AM -5:00 PM CST

## 1. Positioning the charging dock.

- Place charging dock, plug in adapter, signal light on charging dock turn solid.

Tips: Put charging dock against the wall and remove obstacles about 1 meter at two sides and about 2 meters forward.

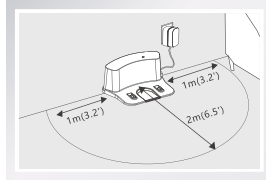

## 2. Wake up and charge your robot

- Turn on the power switch at the side of body, then place your robot on the charging dock for a full charge. When charging is finished, all lights will turn off.
- Tips: During daily use, always keep the robot on charging dock with power turned on.

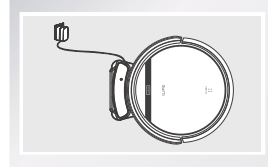
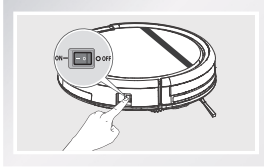

## • V5s Pro is ready to clean

### 1 Switch on the robot

- Make sure the power switch is on.
  - Press CLEAN on the robot or on the remote control to start cleaning.
- \* To switch from sleep mode to select mode, press CLEAN. Press CLEAN again to start cleaning.

### 2 Pause

- Pause the robot to switch from cleaning mode to select mode.
- Press CLEAN button on the robot.
  - Press button on the remote control.

### 3 Sleep

- To turn robot into sleeping mode from selected mode:
- Keep pressing CLEAN button on main body for 3 seconds.
  - Robot enters sleep mode if it does not receive any commands in 15 seconds.

## • Scheduling

### • Setting local time

- Point the remote control towards the robot. (Make sure the power switch is on.)
- Press and then use directional buttons to set the correct time.
- Press to save the setting. To cancel the schedule, please turn off the robot.

### • Setting a schedule

When a schedule is confirmed, robot will start cleaning automatically at the same time every day. If the robot is turned off, you will need to schedule again.

- Point the remote control towards the robot.
- Press and then use directional buttons to set the scheduled.
- Press to save the setting. To cancel the schedule, please turn off the robot.

## • Mopping Mode

- Put the mop cloth to the bracket, then attach it to the bottom of the robot.
- Fill in clean water to the cup, and pour it into the tank carefully. Close the cap until it's full.
- Put the tank into the robot. Press CLEAN on the robot or on the remote control to start mopping.

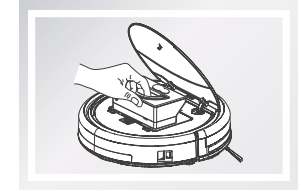
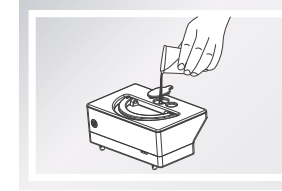
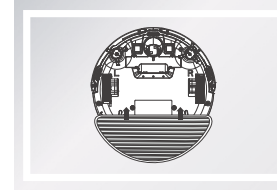

## • Robot Maintenance

- For better cleaning performance, empty dustbin and clean high performance filter after each use (High Performance Filter can't be washed with water). Replace with a new one when it is needed.
- In homes with heavily shedding pets, dustbin may fill quickly with fur or hair. In these cases, you may need to empty dustbin and clean filters more frequently.

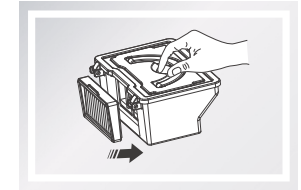
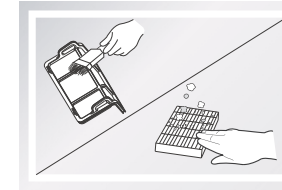
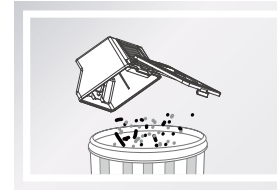

## • Trouble Shooting

### • Error code sheet

When the robot meets with some routine troubles ,it will remind you by beep.

- Short tone

NO.	Tone	Cause	Solution
01	•	Wheels or side brushes disfunction	Check wheels or side brushes
02	••	Cliff sensor or bumper sensor failure	Clean cliff sensor and shake bumper slightly, check whether there is foreign matter
03	•••	Main body gets stuck	Move main body and start again

Note: If all above solutions don't work, please take below actions.

- Re-set the robot by re-turning on the power switch.
- If re-set action doesn't work, please contact support@iliferobot.com